

### Finishes Available

ALUM (A)		Notes	BRASS (B)		Notes
0	No Finish	A	0	No Finish	
1A	Anodize-Mil-A-8625 Type 1 (Chromic) Hot Water Seal (Dk. Grey)		3	Cadmium Plate-QQ-P-416 Class 1 -Clear Chromate Special Order	
1B	Anodize-Mil-A-8625 Type 2 (Sulphuric) Hot Water Seal (Clear)		3B	Cadmium Plate-QQ-P-416 Class 3, Type 2-Color Chromate Special Order	
1C	Anodize-Mil-A-8625 Type 2 (Sulphuric) Dichromate Seal (Yellow/Green)		4	Nickel plate QQN-290 A Grade G	
2	Anodize-Mil-A-8625 Black Type 2		6A	Brass Ebonal "C" (Black) Mil-F-495	
8	Caustic Etch		14	Electro Tin Plate-Mil-T-10727-Type I	
9	Caustic Etch and Lacquer		14A	Electro Tin Solder 60/40 per M230 Mil-F-14072	B
10	Alodine 1200		15	Bright Dip (Brass Finish)	
16	Iridite-Clear-Mil-C-5541		28	Zinc Plate .0002 thick-ASTM-B-633 Type I	A
17	Iridite-Gold-Mil-C-5541		37	Zinc Plate .0002 thick-ASTM-B-633 Type II (Color Chromate)	
<b>STEEL (S)</b>			Note: Brass parts stocked with Zinc Plate finish-28. Refer to chart above for other finishes required. Finish #3 and 3B available on special order.		
0	No Finish		<b>STAINLESS STEEL (SS)</b>		
3	Cadmium Plate-QQ-P-416 Class 3 -Clear Chromate Special Order		6B	Stainless Steel "Black Oxide" Mil-C-13924	
3B	Cadmium plate-QQ-P-416 Class 3, Type 2-Color Chromate Special Order		7	Passivate-QQ-P-35	A
4	Nickel Plate QQ-N-290, A Grade F		<b>PHENOLIC (PH)(PHF)</b>		
14	Electro Tin Plate-Mil-T-10727-Type I		0	No Finish	A
14A	Electro Tin Solder 60/40 Per M230 Mil-F-14072	B	30	Moisture and Fungus Resistant Finish Mil-V-173	
28	Zinc Plate .0002 thick-ASTM-B-633 Type I		<b>NYLON (N)</b>		
37	Zinc Plate .0002 thick-ASTM-B-633 Type II (Color Chromate)		Plain-No finish		
Notes:	(A.) Standard Finish for stocked parts. (B.) Not suitable for 2-56 or smaller threads specify oversized tap when ordering thread sizes.				

### PANEL SCREW RETAINER

(INSERT - SCREW THREAD-PANEL) Per FSC-5305-120

**Type 1:** These panel retainers are designed to be used with type 1 captive screws as listed see pages 68 and 69.

- Material**
- SS-Corrosive Resisting Steel (Stainless Steel): ASTM A581-75 thru 1/2 O.D. over 1/2 AMS-5762.
  - B-Brass: QQ-B-626 Comp 22 1/2 Hard.

- Standard Finish**
- For Corrosive Resisting Steel (SS): Passivate per QQ-P-35.
  - For Brass (B): Nickel Plate - QQ-N-290 Grade G.

- Threads**
- UNC-2B and UNF-2B per National Bureau of Standards Handbook H28 titled "Screw-Thread Standards for Federal Services."

- Workmanship**
- To high precision standards.

- Quality Control**
- To MIL-STD-105. Made for use on government equipment.

#### TYPE 1 (Refer to Table 14)

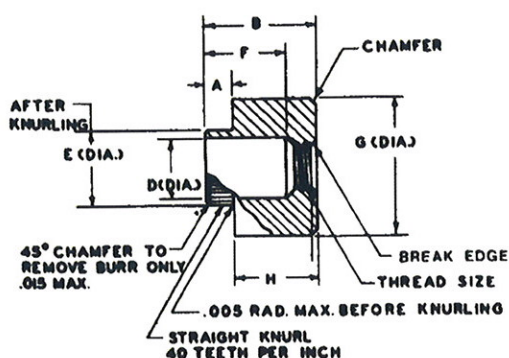

#### NOTES:

- Available in other materials on special order. Price on Application.
- Any similar type captive panel retainer in any increment of body or thread size is available on special order. Price on Application.
- CHAMFER - UNDER 1/2 inch "G" dimension, chamfer is 1/64 x 45°. 1/2 inch "G" dimension and over, chamfer is 1/32 x 45°.
- X-Hole - Size for Press Fit See Table 20, page 81.

#### TABLE 15

CODE FOR SHANK LENGTH (A DIM.)

CODE	LENGTH OF SHANK	PANEL THICKNESS
A	.050	.048-.072
B	.080	.074-.109
C	.125	.119-.156
D	.188	.188
E	.250	.250

Note: For special shank lengths contact Amatom sales office for part numbers.

#### TABLE 14 - Type 1

PART NO./MATERIAL		THREAD SIZE	PANEL THICKNESS RANGE	A ±.005	REF. B ±.010	D ±.005	E +.003 -.000	F ±.005	G ±.003	H ±.005
BRASS (B)	CRES (SS)									
6250A-B-0440	6250A-SS-0440	4-40 UNC-2B	.048-.072	.050	1/4	.140	.198	.1640	1/4	.200
6250B-B-0440	6250B-SS-0440		.074-.109	.080						.170
6250C-B-0440	6250C-SS-0440		.119-.156	.125						.125
6251A-B-0632	6251A-SS-0632	6-32 UNC-2B	.048-.072	.050	5/16	.150	.198	.2150	1/4	.262
6251B-B-0632	6251B-SS-0632		.074-.109	.080						.232
6251C-B-0632	6251C-SS-0632		.119-.156	.125						.187
6251D-B-0632	6251D-SS-0632		.188	.188						.124
6252A-B-0832	6252A-SS-0832	8-32 UNC-2B	.048-.072	.050	5/16	.188	.228	.2110	5/16	.262
6252B-B-0832	6252B-SS-0832		.074-.109	.080						.232
6252C-B-0832	6252C-SS-0832		.119-.156	.125						.187
6252D-B-0832	6252D-SS-0832		.188	.188						.124
6253A-B-1024	6253A-SS-1024	10-24 UNC-2B	.048-.072	.050	3/8	.228	.280	.2380	3/8	.325
6253B-B-1024	6253B-SS-1024		.074-.109	.080						.295
6253C-B-1024	6253C-SS-1024		.119-.156	.125						.250
6253D-B-1024	6253D-SS-1024		.188	.188						.187
6253E-B-1024	6253E-SS-1024		.250	.250						.125

continued...

5 Pasco Hill Road • Cromwell, CT 06416-1093

Phone: 860-828-0847 • Call Toll Free: 800-243-6032 • Fax: 860-828-0381

Web Address: <http://www.amatom.com> • E-Mail: [sales@amatom.com](mailto:sales@amatom.com)